

SPEED SENSOR FRONT LH

REPLACEMENT

HINT:

Replace the RH side by the same procedures with LH side.

1. **REMOVE FRONT WHEEL**
2. **REMOVE FRONT FENDER LINER LH**

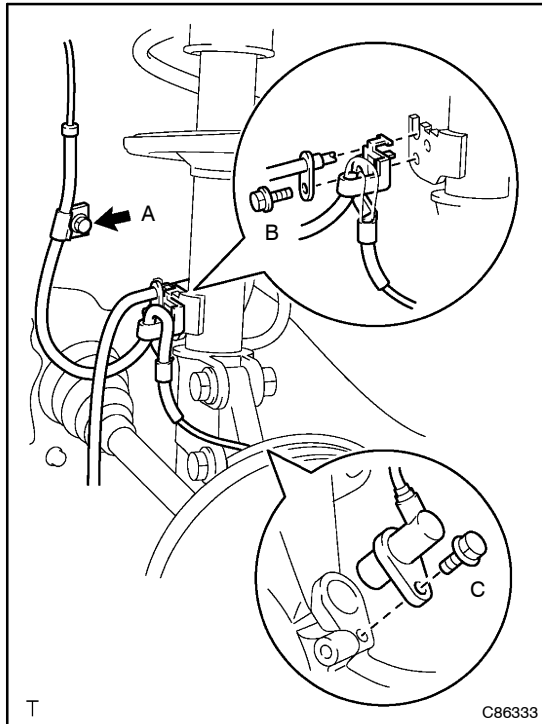

3. REMOVE SPEED SENSOR FRONT LH

- (a) Disconnect the speed sensor connector.
- (b) Remove the bolt A and separate the sensor harness clamp from the body.
- (c) Remove the bolt B and separate the sensor harness clamp from the shock absorber.
- (d) Remove the bolt C and speed sensor FR LH.

NOTICE:

Do not stick any foreign matter on the sensor tip.

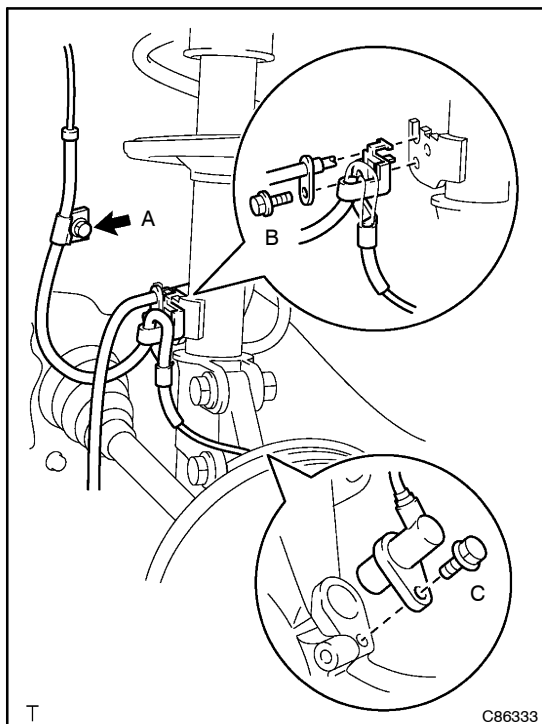

4. INSTALL SPEED SENSOR FRONT LH

- (a) Install the speed sensor FR LH with the bolt C.
Torque: 7.8 N·m (80 kgf·cm, 70 in·lbf)

NOTICE:

Do not put on foreign matter on the sensor tip.

- (b) Install the sensor harness clamp with the 2 bolts "A" and "B" to the body and shock absorber.

Torque:

Bolt A: 7.8 N·m (80 kgf·cm, 70 in·lbf)

Bolt B: 18.5 N·m (189 kgf·cm, 13.6 ft·lbf)

- (c) Connect the speed sensor connector.

5. INSTALL FRONT FENDER LINER LH

6. INSTALL FRONT WHEEL

Torque: 103 N·m (1,050 kgf·cm, 76 ft·lbf)

7. CHECK ABS SPEED SENSOR SIGNAL ([See page 05-295](#))